



# Gourmet 1011 Vision

## Electrical Supply

**CODE:** 925907630

### Technical features

|                      |  |
|----------------------|--|
| Seats:               | 80/160   |
| Outside dimension:   | 715 L x 800 P x 1000 H mm  |
| Space between trays: | 65 mm  |
| Trays:               | 10T GN 1/1   |
| Power:               | 11 KW  |
| Weight:              | 80 Kg  |
| Max temperature:     | 270 ° C  |
| Power supply:        | 400 V ~ 3PH + N + PE   400 V ~ 2PH + N + PE   230 V ~ 3PH + PE   230 V ~ 1PH + N + PE   50-60 Hz |

### Equipment

|                             |                                |  |
|-----------------------------|--------------------------------|--|
| Capacitive Touch screen 7"  | 6 Cooking modes                | 5 Fan speeds                           |
| LED lighting                | Core probe                     | HACCP register                         |
| Pre-heating option          | Controlled steam injection (%) | Inner and online collection of recipes |
| Cooling system              | Fan inversion system           | Multi-timer tray cooking end           |
| 10 Phases for cooking       | Multipoint probe               | Glass opening for cleaning             |
| Delayed cooking programming | Error reporting                | USB port                               |
| ??                          |                                |  |

### Accessories

Cabinets, Blast chillers, Exhaust & draining, Cleaning & purification, Control tools, Stands & supports, Trays

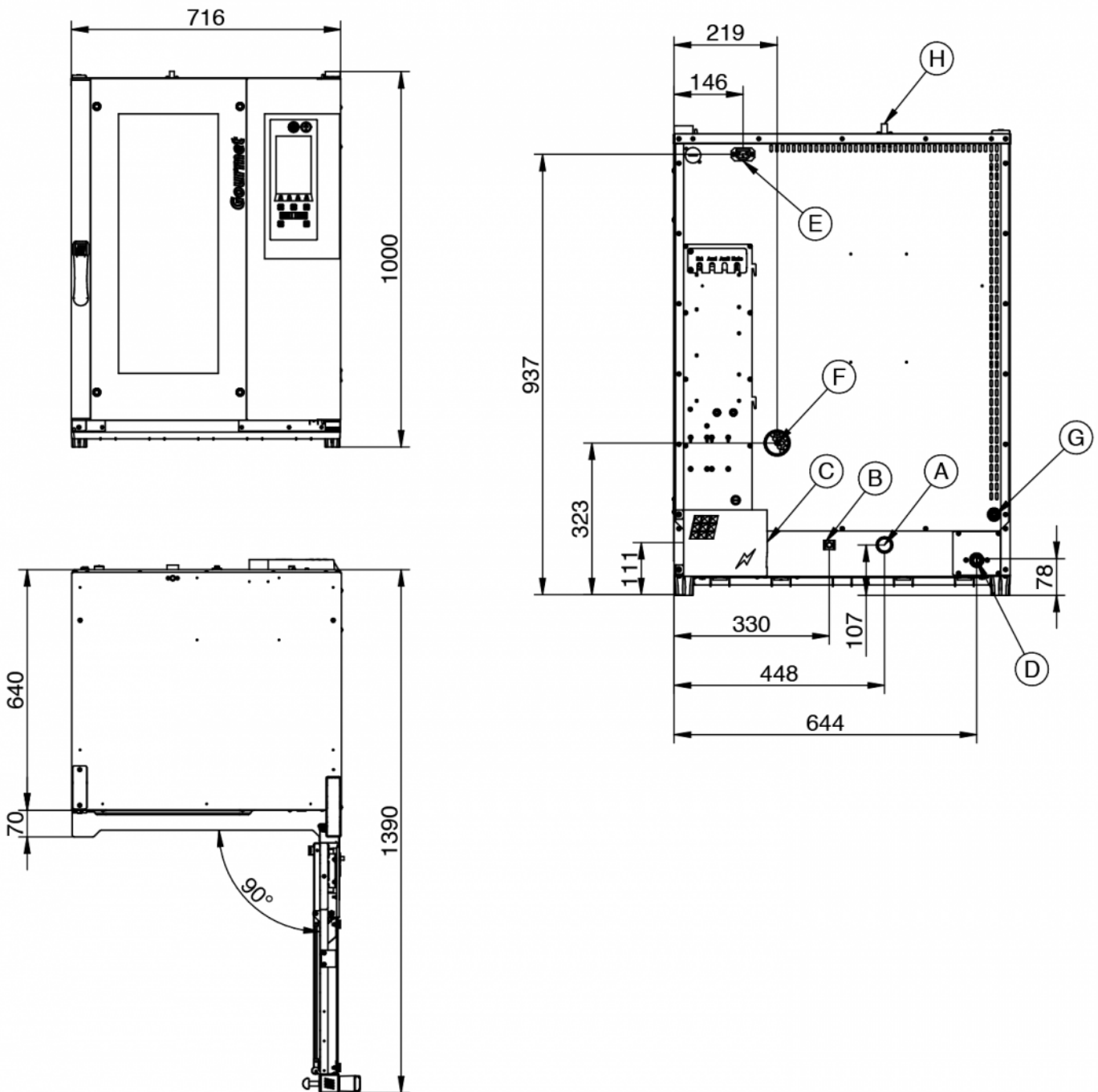
**Gourmet 1011 Vision**
**Electrical Supply**

**Legend**

- A - Drain liquid Ø 30mm
- B - Equipotential terminal comb
- C - Electric supply
- D - Water inlet 3/4"
- E - Extracting hood supply
- F - Steam exhaust Ø 50mm
- G - Inlet for washing kit Ø 8mm
- H - Depressurizer Ø 12mm

**Gourmet 1011 Vision**

**Electrical Supply**

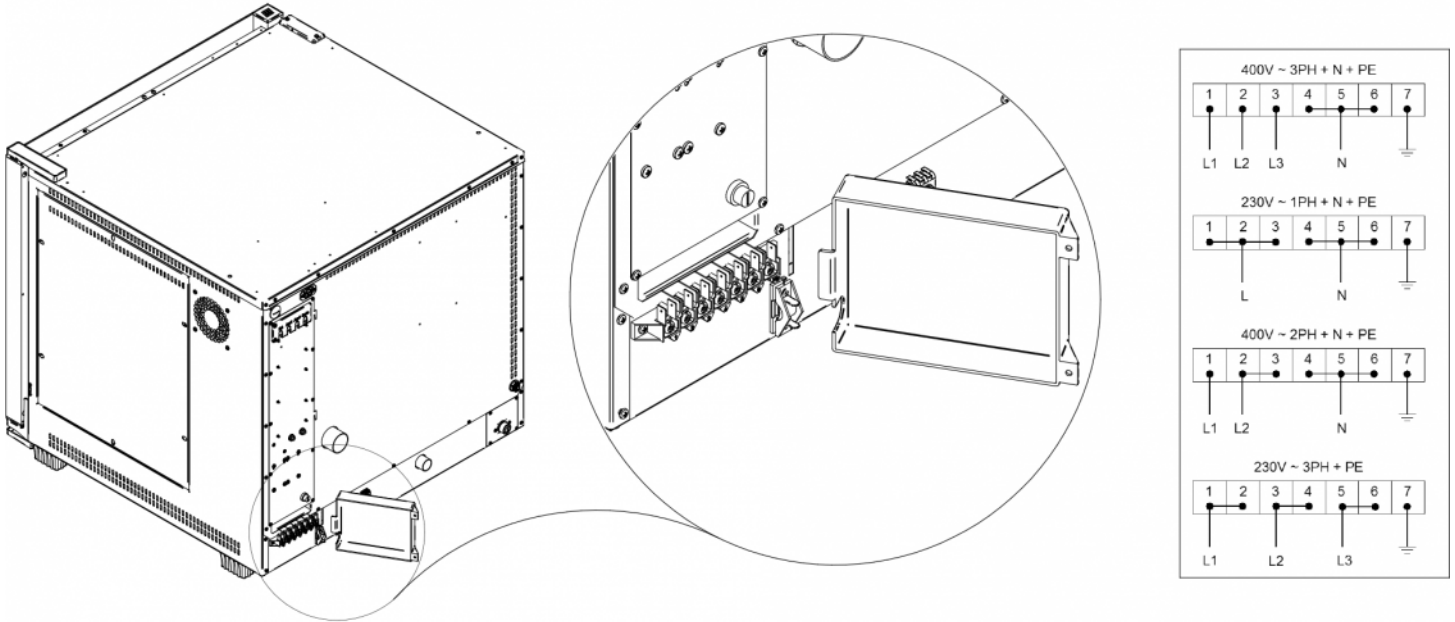
**Connections**



**Packaging**

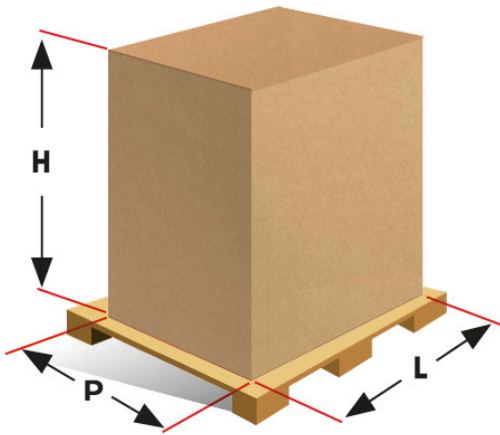

|               |                                  |
|---------------|----------------------------------|
| Packing size: | <b>790 L x 870 P x 1140 H mm</b> |
| Net weight:   | <b>87 Kg</b>                     |
| Gross weight: | <b>96 Kg</b>                     |